

TECHNICAL DATA SHEET

FABX2 OS - Off Shore Block

TDS 28



FABX2 OS 18m Retractable Life Line Technical Data Sheet

Checkmate Xcalibre FABX2 OS is designed to be used in harsh environments where it may be permanently installed. It is comprised entirely of materials with an offshore corrosion protection. Can form part of a full safe transfer system including a ladder davit and a permanent tag line.



Xcalibre

SAFETY BY DESIGN

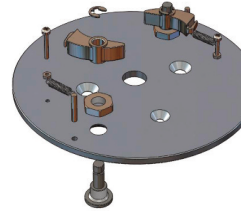

Brake Pawls & Plate

Manufactured from aluminium alloy T6 and hard anodised, this plate retains the hardened stainless pawls and spindles.



Sealed Brake Module

The brake module is a stainless/alloy unit which can be easily replaced after a fall, the "O" rings provide a seal from dust and water ingress.



Housings

The clear PC/ABS housing gives the block its lightness and allows for visual inspection of the enclosed mechanical assembly without the need for removal of the block from its housing.



Load Bearing Chassis

The chassis comprises of two stainless steel hangers which give the block its strength.



Ladder Davit

Optional made to order Stainless steel davit extends the block above the top rung



* Stainless Steel Load Indicating Swivel Hook

Supplied with a marine grade stainless steel load indicating swivel hook as standard, or a marine grade stainless steel load indicating swivel eye (MoQ's apply).



Thermally insulated protective hood

The optional hood protects the blocks exterior and regulates extreme temperature changes reducing condensation build up.

TDS 28 - ISSUE 04

ordering information

Part No.	Description	Weight
▼ FABX2-OS-18F	18m/60ft Dyneema Rope	5.6kg/12.3lbs
▼ FABX2-OS-15CS	15m/50ft Stainless Steel Cable	7kg/15.4lbs
▼ OSD2-000	Ladder Davit	17kg/37.5lbs

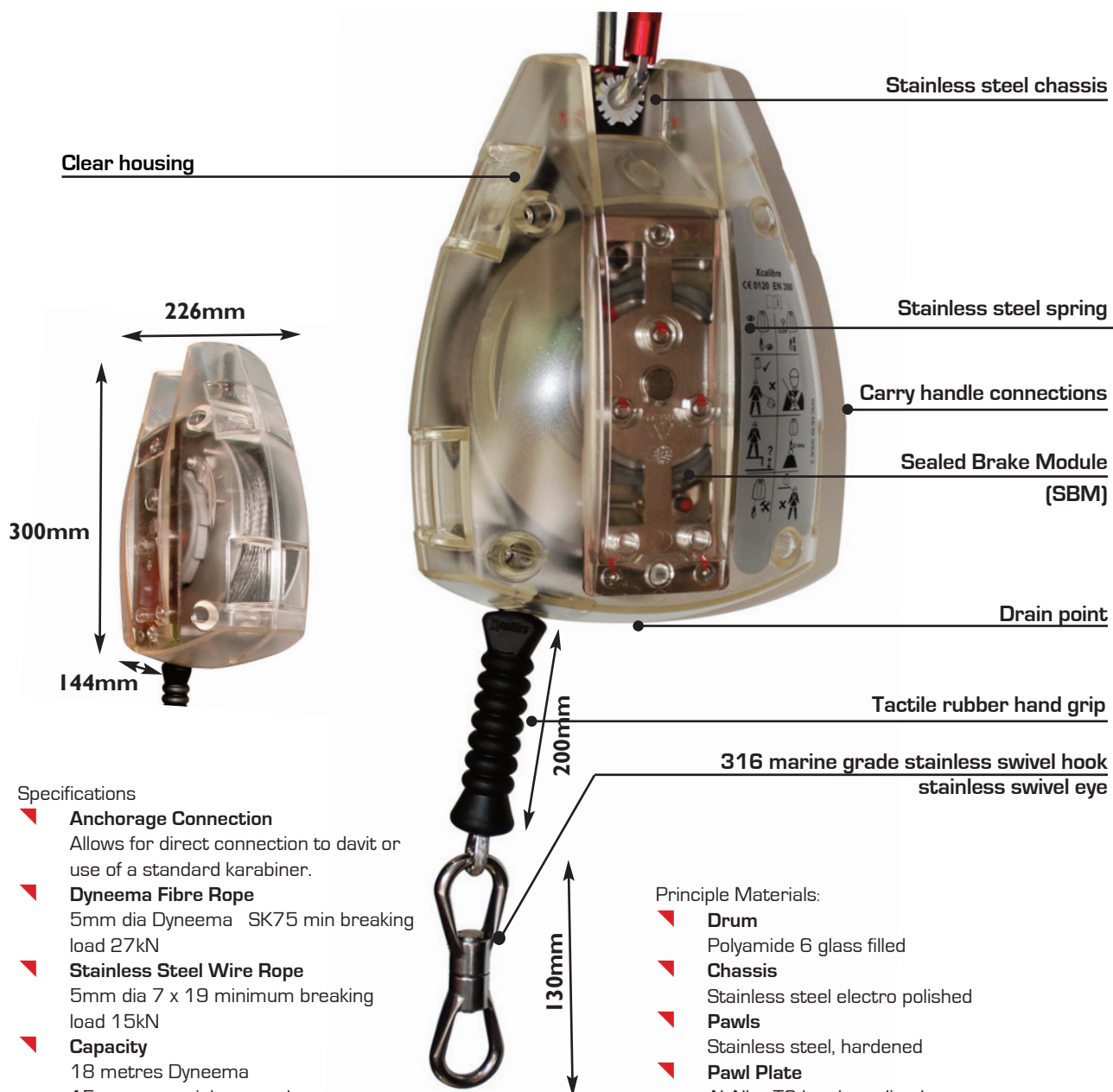

Specifications

- ▼ **Anchorage Connection**
Allows for direct connection to davit or use of a standard karabiner.
- ▼ **Dyneema Fibre Rope**
5mm dia Dyneema SK75 min breaking load 27kN
- ▼ **Stainless Steel Wire Rope**
5mm dia 7 x 19 minimum breaking load 15kN
- ▼ **Capacity**
18 metres Dyneema
15 metres stainless steel
- ▼ **Maximum Arresting Force**
Dyneema rope = 3.5kN
Wire rope = 4.5kN
- ▼ **Total Arrest Distance**
2m maximum
- ▼ **User Weight**
136Kg maximum

Standards:

- ▼ EN 360
- ▼ AS NZS 1891.3.1997
- ▼ ANSI Z359.14:2012 Class B

Principle Materials:

- ▼ **Drum**
Polyamide 6 glass filled
- ▼ **Chassis**
Stainless steel electro polished
- ▼ **Pawls**
Stainless steel, hardened
- ▼ **Pawl Plate**
Al Alloy T6 hard anodised
- ▼ **Pawl Spindles & Spring**
Stainless steel
- ▼ **Housing**
PC/ABS
- ▼ **Ratchet**
Al Alloy T6 hard anodised
- ▼ **Bearings**
Polyamide with PTFE
- ▼ **Shaft**
Al Alloy T6 hard anodised
- ▼ **Swivel Hook Or Eye**
Stainless steel rated to 23kN



CHECKUSOUT

www.checkmateuk.com

